



ADDENDUM NO. 3

DANBURY TOWNSHIP PUMP STATION IMPROVEMENTS, PHASE 2

OTTAWA COUNTY, OHIO

PDG JOB NO. 308500-00118

JULY 6, 2021

I. Technical Specifications

A. Section 01 1000 – Summary

1. Part 1.3, A, 1, b, add as follows; **5) Remove top concrete section of access manhole to the wet well. Install new 4' diameter concrete riser section, precast concrete top slab, and 24" x 36" aluminum access hatch as detailed on the plans.**
2. Part 1.3, A, 1, e; add as follows; **6) Remove top concrete section of access manhole to the wet well. Install new 4' diameter concrete riser section, precast concrete top slab, and 24" x 36" aluminum access hatch as detailed on the plans.**

II. Technical Drawings

A. Sheet 4 – Whitecaps Pump Station #2

1. This drawing has been reissued to show modifications to the access manhole to the pump station wet well.

B. Sheet 7 – Bay Point Pump Station #5

1. This drawing has been reissued to show modifications to the access manhole to the pump station wet well and the modifications to the installation of the bypass inlet within the wet well.

III. Clarifications

- A. The contractor will be allowed a temporary closure of E Bayshore Road while work within the wet well of the Whitecaps Pump Station #2 is completed to accommodate bypass pumping. The contractor will be responsible for all closure and detour signage in accordance with the Ohio Manual of Uniform Traffic Control Devices for the duration of the closure.

IV. Planholders List

- A. A planholders list is available online for your reference at www.poggemeyer.com. click on BIDS and find the project.

ANY INFORMATION OR DATA ON THIS DRAWING IS NOT INTENDED TO BE SUITABLE FOR REUSE BY ANY PERSON, FIRM OR CORPORATION OR ANY OTHERS ON EXTENSIONS OF THIS PROJECT OR FOR ANY USE ON ANY OTHER PROJECT WITHOUT WRITTEN VERIFICATION AND ADAPTATION BY THE ENGINEER, ARCHITECT OR SURVEYOR FOR THE SPECIFIC PURPOSE. INTENDED WILL BE AT THE USER'S SOLE RISK AND WITHOUT LIABILITY TO THE ENGINEER, ARCHITECT OR SURVEYOR.

FILE No. I:\308500\00118\ENV\CIVIL3D\DWGS\04.dwg 06/29/21 15:39-R01ey

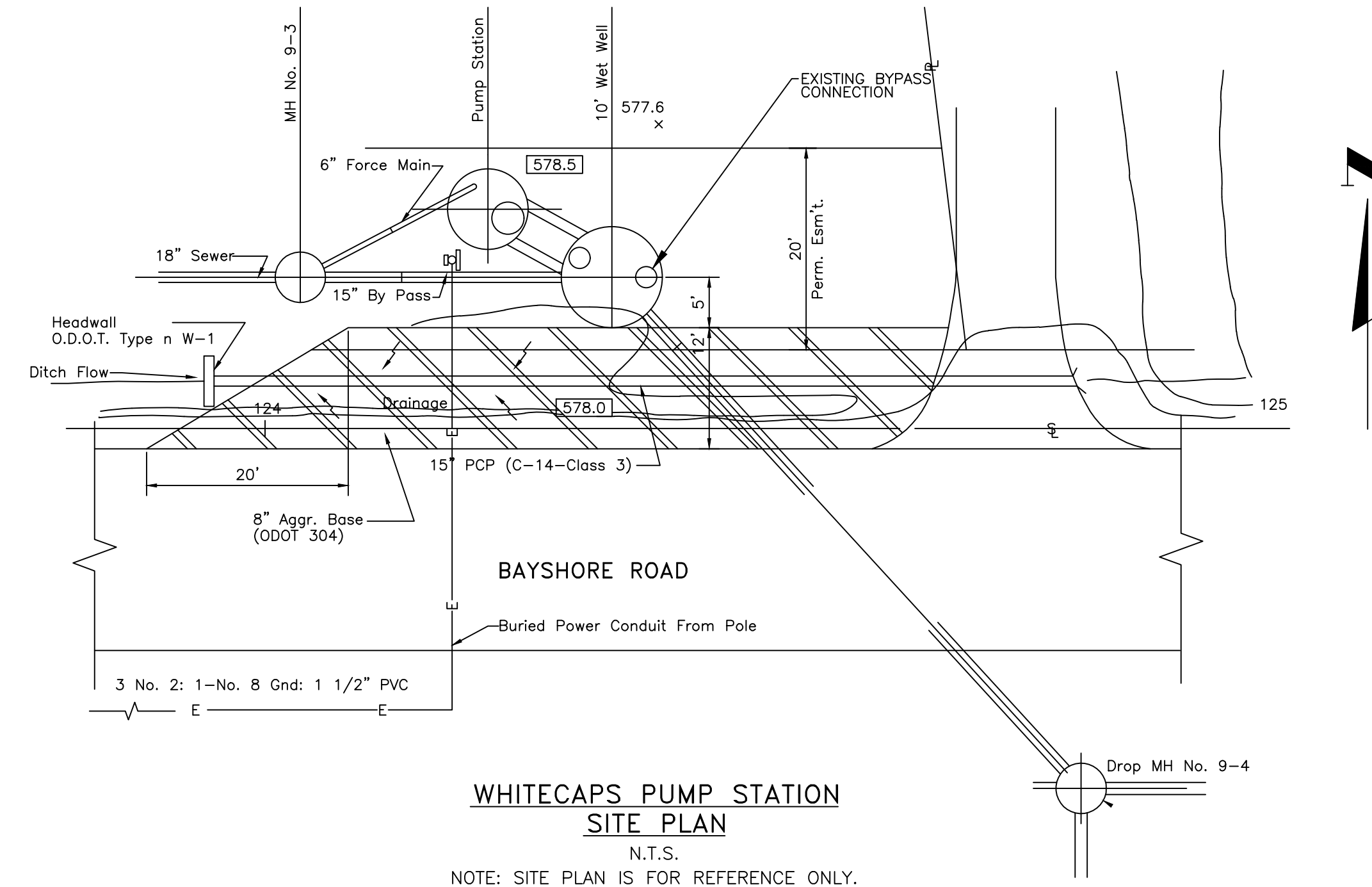
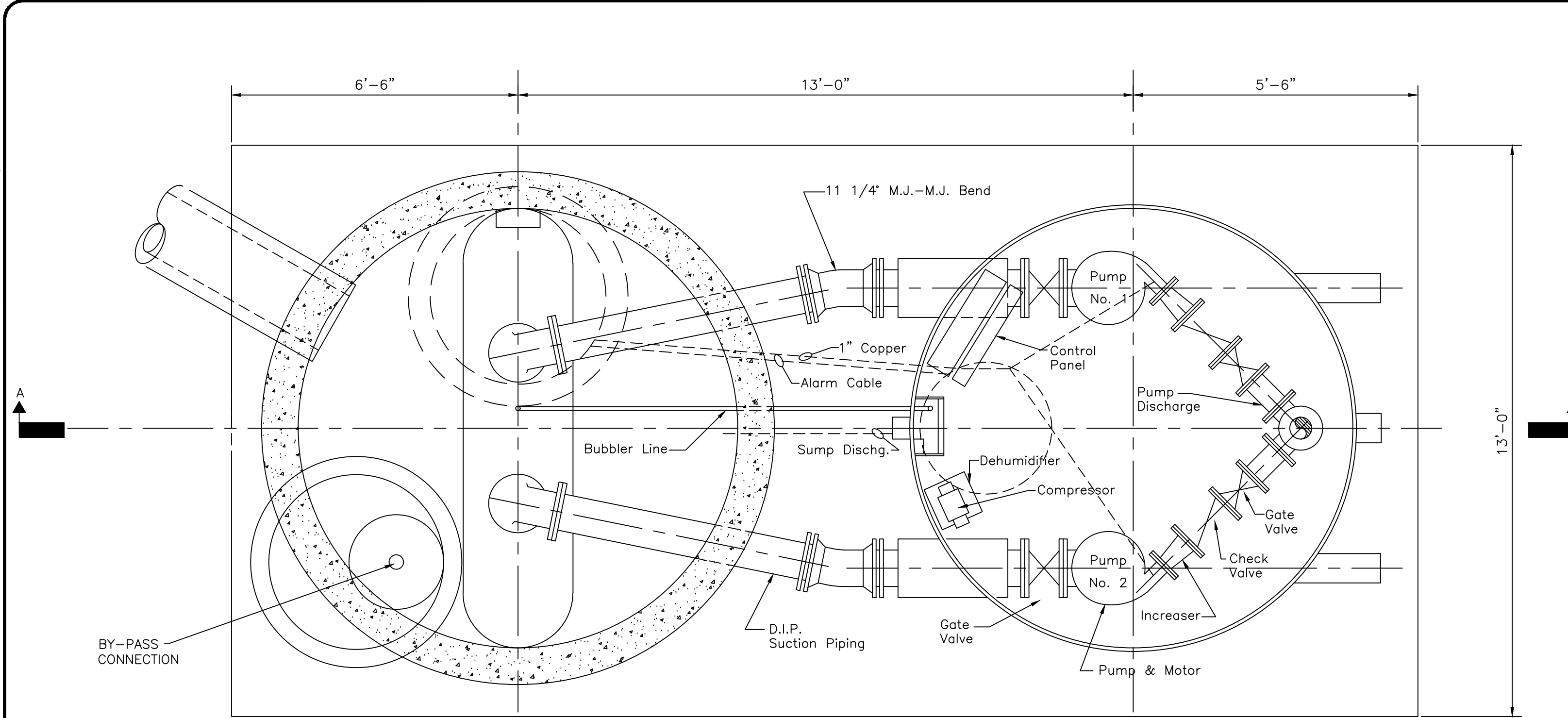

WHITECAPS PUMP STATION SITE PLAN

N.T.S.
NOTE: SITE PLAN IS FOR REFERENCE ONLY. CONTRACTOR IS TO VERIFY LOCATIONS OF ALL UTILITIES

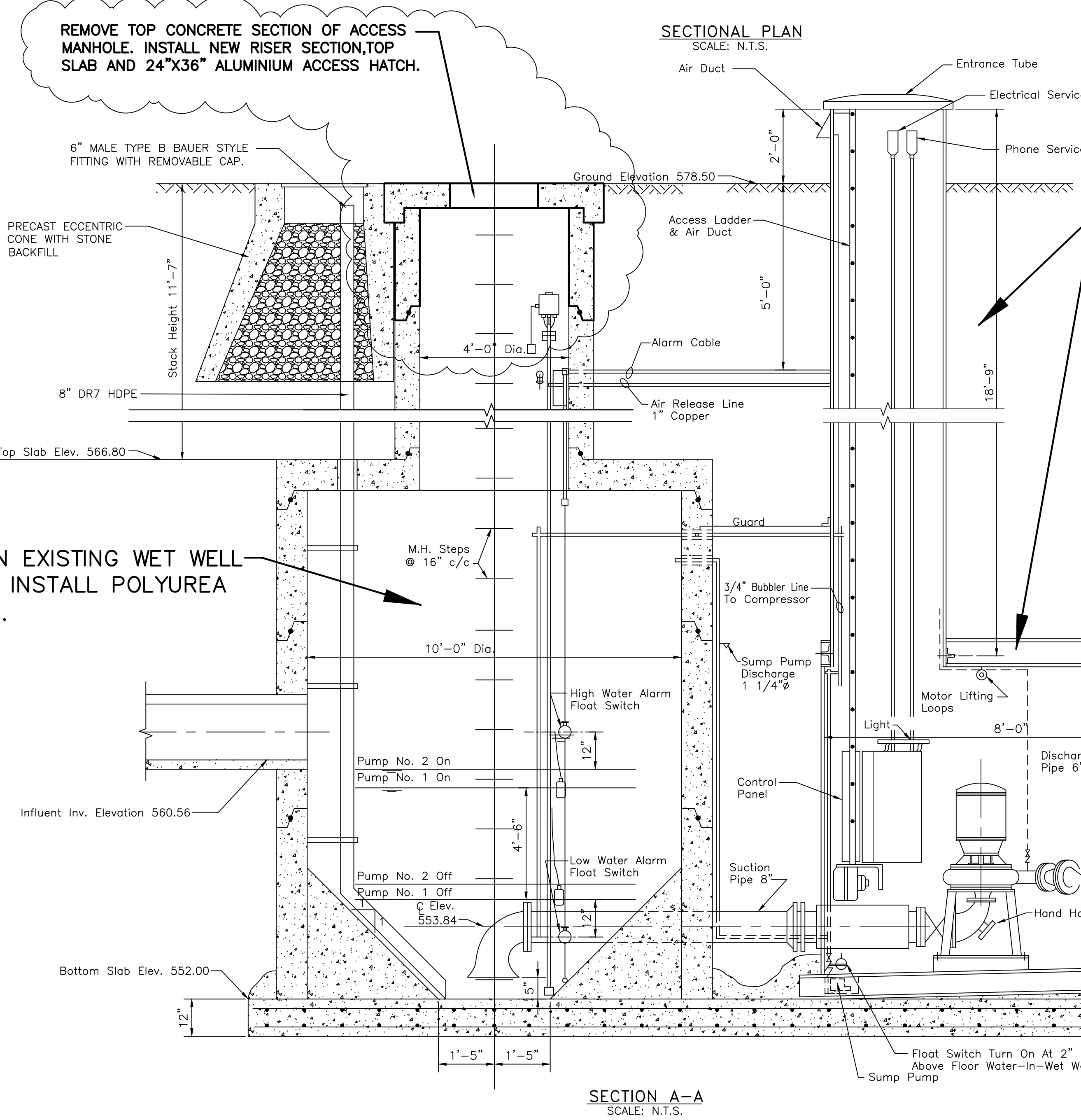

SECTION A-A
SCALE: N.T.S.

NOTE: INTERIOR OF EXISTING DRY WELL SHALL BE ABRASIVE BLAST CLEANED AND PREPARED FOR COATING AND PAINTING IN ACCORDANCE WITH SPECIFICATIONS. WORK TO INCLUDE ACCESS SHAFT, PUMPS, PIPING, VALVES ETCETERA

NOTE: ALL HARDWARE WITHIN THE WET WELL TO BE 316 STAINLESS STEEL.

NOTE: A MINIMUM OF TEN (10) FEET HORIZONTALLY AND EIGHTEEN (18) INCHES VERTICALLY FROM ANY SANITARY SEWER OR SEPTIC LINE MUST ALWAYS BE MAINTAINED UNLESS OTHERWISE APPROVED BY THE OHIO EPA. NO ENTRY OR CONTACT WITH A SEWER MANHOLE IS PERMITTED.

NOTE: IT IS THE CONTRACTOR'S RESPONSIBILITY TO SUPPORT AND PROTECT ALL UTILITIES EXPOSED DURING ANY EXCAVATION PERFORMED AS A RESULT

NOTE: ROOF DRAINS, FOUNDATION DRAINS, AND OTHER CLEAN WATER CONNECTIONS TO THE SANITARY SEWER ARE PROHIBITED.

NOTE: PUMP STATION SHALL BE POWERED DOWN AND REMOVED FROM SERVICE FOR THE DURATION OF THE DRY WELL PREPARATORY AND COATING PROCESS.

CONTRACTOR TO PROVIDE TEMPORARY CONTINUOUS BY-PASS PUMPING DURING CONSTRUCTION. PUMPS MUST BE SIZED TO HANDLE EXISTING FLOW. MINIMUM OF TWO (2) PUMPS REQUIRED AT ALL TIMES.

EXISTING WET WELL CONCRETE SURFACE TO BE PRESSURE WASHED. DETERIORATED CONCRETE AND/OR LEAKS WITHIN THE WET WELL SHALL BE PATCHED/PLUGGED AS NECESSARY IN ACCORDANCE WITH THE SPECIFICATIONS.

EXISTING EQUIPMENT WITHIN THE WET WELL TO BE REMOVED AND REINSTALLED AFTER REQUIRED CURE TIME WITH NEW HARDWARE.

POLYUREA LINER SHALL BE APPLIED TO ALL NEW AND EXISTING PIPING WITHIN THE WET WELL.

PUMP STATION DESIGN POINT 1,100 GPM @ 26' TDH
NEW IMPRESSED CURRENT CATHODIC PROTECTION SYSTEM TO BE INSTALLED BY AEGION CORRPRO. CONTRACTOR IS RESPONSIBLE FOR PROVIDING POWER TO NEW IMPRESSED CURRENT SYSTEM FROM PUMP STATION. SEE DETAIL SHEET E-001.

High Water Alarm	560.50
Pump No.2 On	559.50
Pump No.1 On	559.00
Pump No.2 Off	555.00
Pump No.1 Off	554.50
Low Water Alarm	553.84

ANY INFORMATION OR DATA ON THIS DRAWING IS NOT INTENDED TO BE SUITABLE FOR REUSE BY ANY PERSON, FIRM OR CORPORATION OR ANY OTHERS ON EXTENSIONS OF THIS PROJECT OR FOR ANY USE ON ANY OTHER PROJECT WITHOUT WRITTEN VERIFICATION AND ADAPTATION BY THE ENGINEER, ARCHITECT OR SURVEYOR FOR THE SPECIFIC PURPOSE. REUSE, INTENDED OR NOT, AT THE USER'S SOLE RISK AND WITHOUT LIABILITY OF THE ENGINEER, ARCHITECT OR SURVEYOR.

FILE No. I:\308500\00118\ENV\CIVIL3D\DWGS\07.dwg 06/29/21 15:19--Rotley

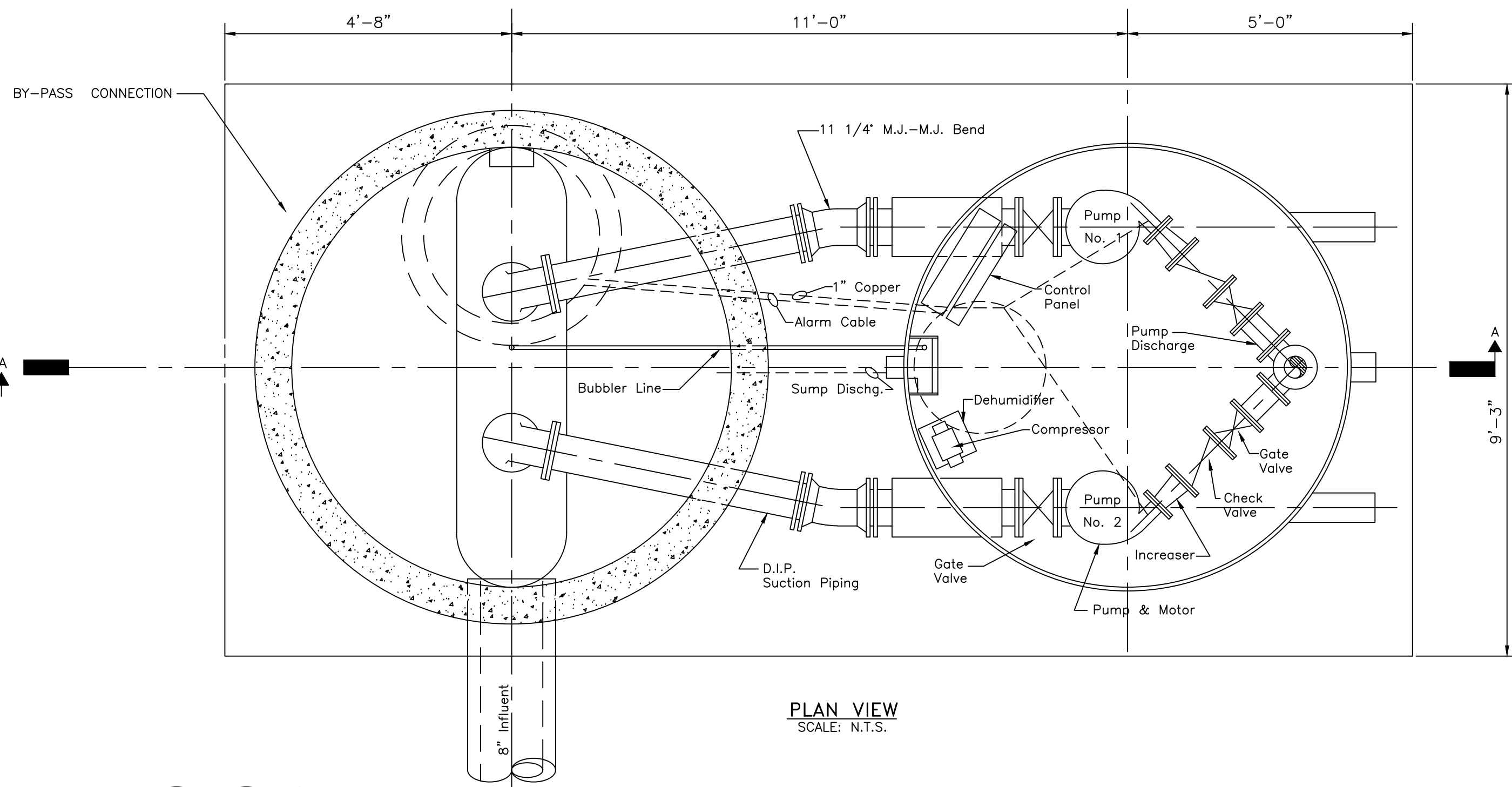

NOTE: A MINIMUM OF TEN (10) FEET HORIZONTALLY AND EIGHTEEN (18) INCHES VERTICALLY FROM ANY SANITARY SEWER OR SEPTIC LINE MUST ALWAYS BE MAINTAINED UNLESS OTHERWISE APPROVED BY THE OHIO EPA. NO ENTRY OR CONTACT WITH A SEWER MANHOLE IS PERMITTED.

NOTE: IT IS THE CONTRACTOR'S RESPONSIBILITY TO SUPPORT AND PROTECT ALL UTILITIES EXPOSED DURING ANY EXCAVATION PERFORMED AS A RESULT OF THIS PROJECT

NOTE: ROOF DRAINS, FOUNDATION DRAINS, AND OTHER CLEAN WATER CONNECTIONS TO THE SANITARY SEWER ARE PROHIBITED.

NOTE: PUMP STATION SHALL BE POWERED DOWN AND REMOVED FROM SERVICE FOR THE DURATION OF THE DRY WELL PREPARATORY AND COATING PROCESS.

NOTE: POLYUREA LINER SHALL BE APPLIED TO ALL NEW AND EXISTING PIPING WITHIN THE WET WELL.

NOTE: EXISTING EQUIPMENT WITHIN THE WET WELL TO BE REMOVED AND REINSTALLED AFTER REQUIRED CURE TIME WITH NEW HARDWARE.

NOTE: ALL NEW HARDWARE WITHIN THE WET WELL SHALL BE 316 STAINLESS STEEL.

NOTE: EXISTING WET WELL CONCRETE SURFACE TO BE PRESSURE WASHED. DETERIORATED CONCRETE AND/OR LEAKS WITHIN THE WET WELL SHALL BE PATCHED/PLUGGED AS NECESSARY IN ACCORDANCE WITH THE SPECIFICATIONS.

CONTRACTOR TO PROVIDE TEMPORARY BY-PASS PUMPING DURING CONSTRUCTION. PUMPS MUST BE SIZED TO HANDLE EXISTING FLOW. MINIMUM OF TWO (2) PUMPS ARE REQUIRED AT ALL TIMES.

NEW IMPRESSED CURRENT CATHODIC PROTECTION SYSTEM TO BE INSTALLED BY AEGION CORRPRO. CONTRACTOR IS RESPONSIBLE FOR PROVIDING POWER TO NEW IMPRESSED CURRENT SYSTEM FROM PUMP STATION. SEE DETAIL SHEET E-001.

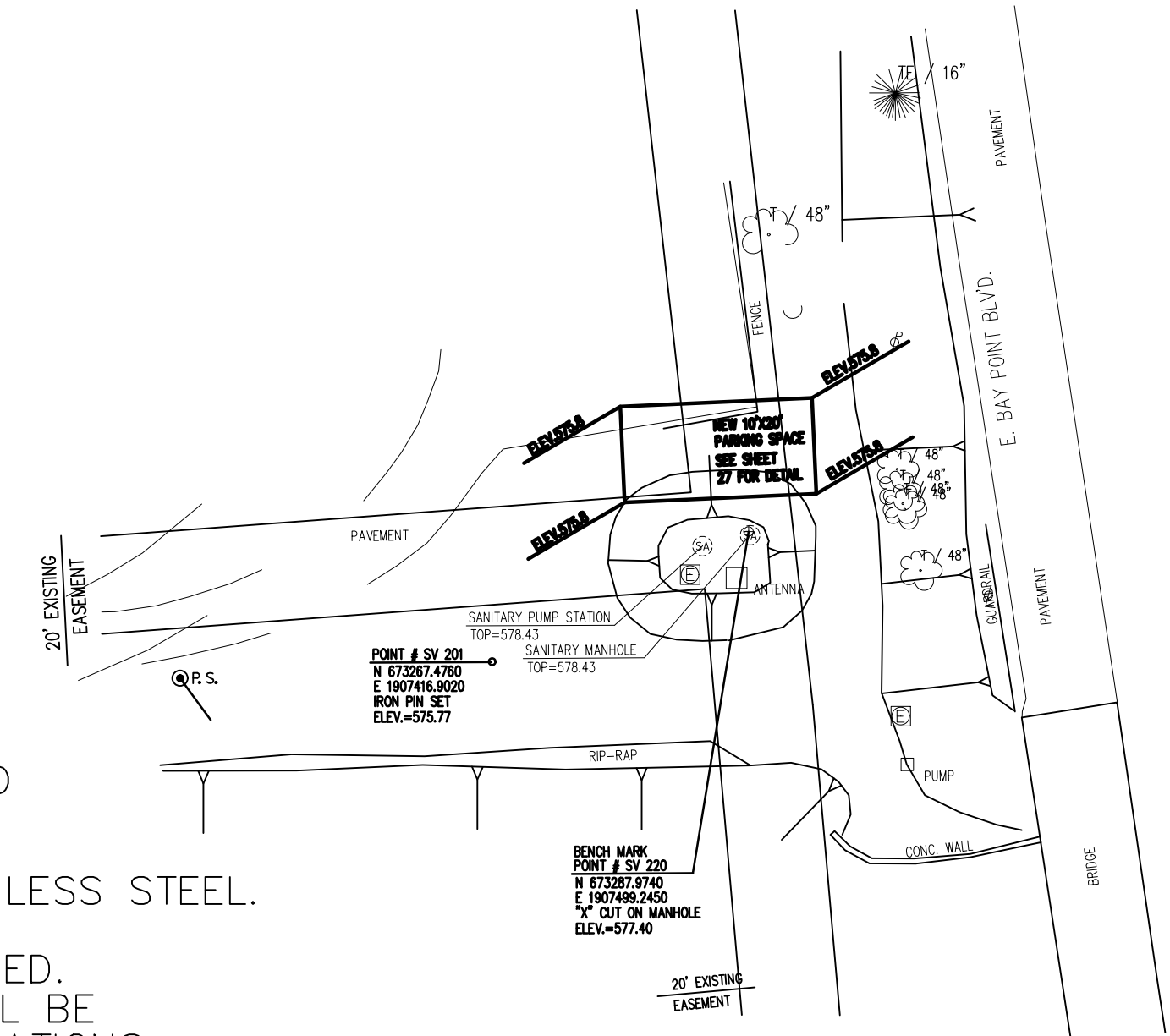

BAY POINT PUMP STATION SITE PLAN
SCALE: N.T.S.

NOTE: SITE PLAN IS FOR REFERENCE ONLY. CONTRACTOR IS TO VERIFY LOCATIONS OF ALL UTILITIES.

REMOVE TOP CONCRETE SECTION OF ACCESS MANHOLE. INSTALL NEW RISER SECTION, TOP SLAB AND 24"x36" ALUMINUM ACCESS HATCH.

6" FEMALE TYPE B BAUER STYLE FITTING WITH REMOVEABLE CAP.

CORE DRILL NEW TOP SLAB. INSTALL NEW 8" DR7 HDPE BYPASS.

8" DR7 HDPE

INSTALL STAINLESS STEEL PIPING SUPPORTS AS REQUIRED

CLEAN EXISTING WET WELL AND INSTALL POLYUREA LINER

SECTIONAL PLAN
SCALE: N.T.S.

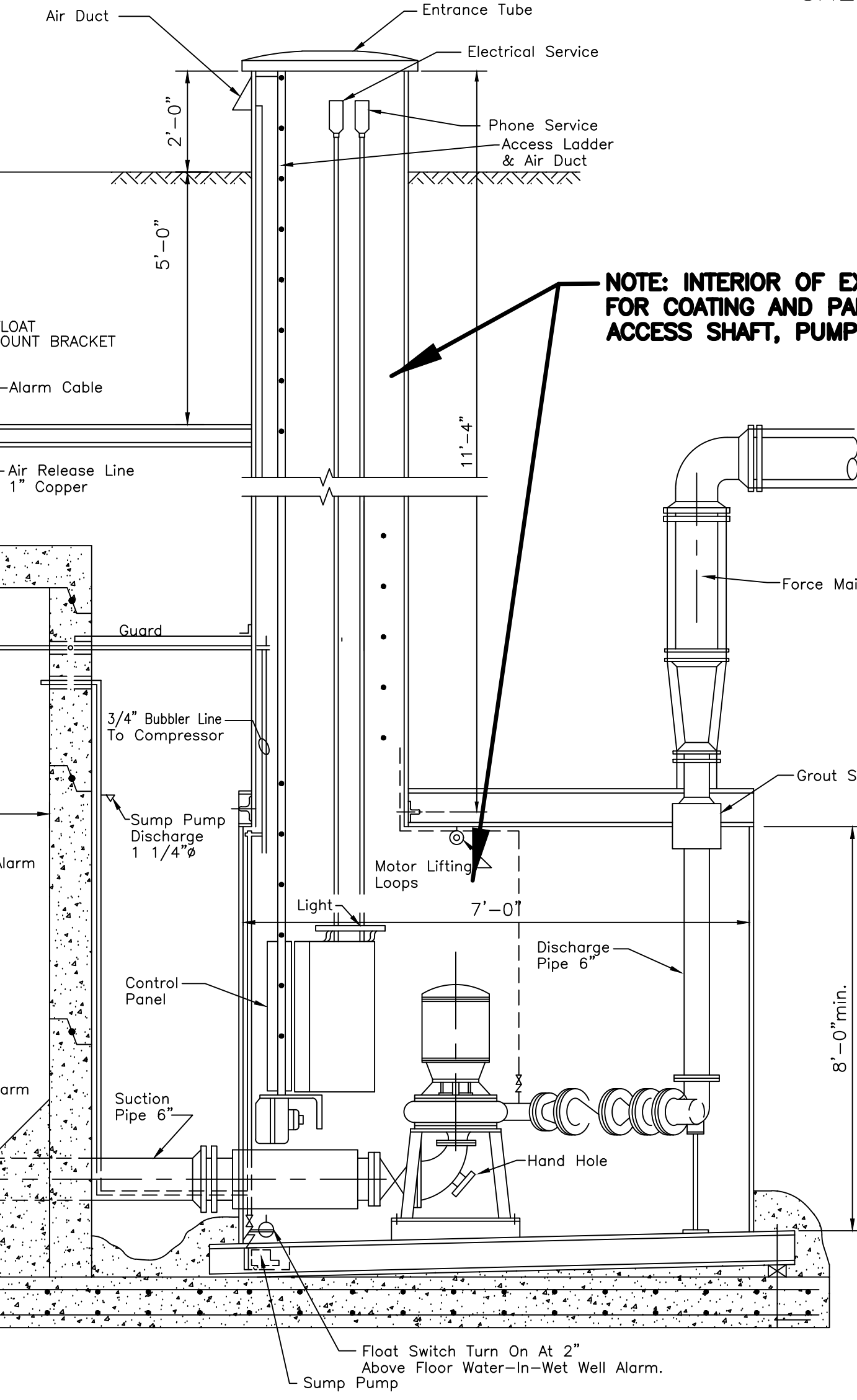

NOTE: INTERIOR OF EXISTING DRY WELL SHALL BE ABRASIVE BLAST CLEANED AND PREPARED FOR COATING AND PAINTING IN ACCORDANCE WITH SPECIFICATIONS. WORK TO INCLUDE ACCESS SHAFT, PUMPS, PIPING, VALVES ETCETERA

High Water Alarm	561.70
Pump No.2 On	561.70
Pump No.1 On	561.20
Pump No.2 Off	557.70
Pump No.1 Off	557.20
Low Water Alarm	556.70

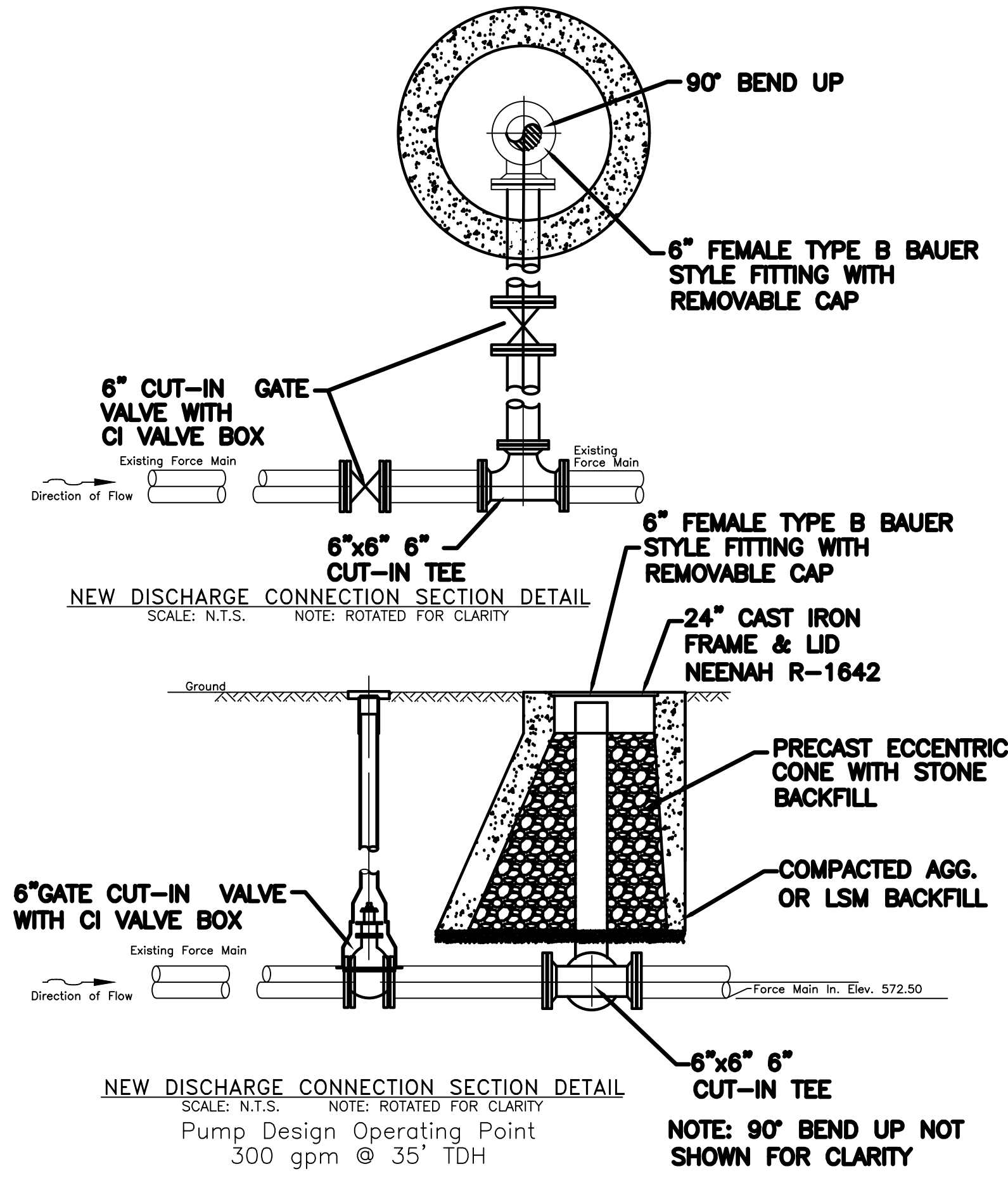

BAY POINT PUMP STATION #5